

TUSTUMENA ELEMENTARY ROOM ASSIGNMENTS

- 102 Pollock, Intervention/Quest
- 114 VANSUN, Speech /Lampon Adapt PE
- 104 FOWLER, PS/Title I
- 105 Gossett, Gr. 3
- 106 Bosick, Gr. 2
- 113 Hopkins, Gr.1
- 103 Roy, Gr. 3
- 115 Granger, Kindergarten
- 134 Walle, Intensive
- 124 Intensive Needs
- 141 Library
- 158 PE
- 142 B&G Club
- 143 Dell Lab
- 144 Music/Band
- 112 OT

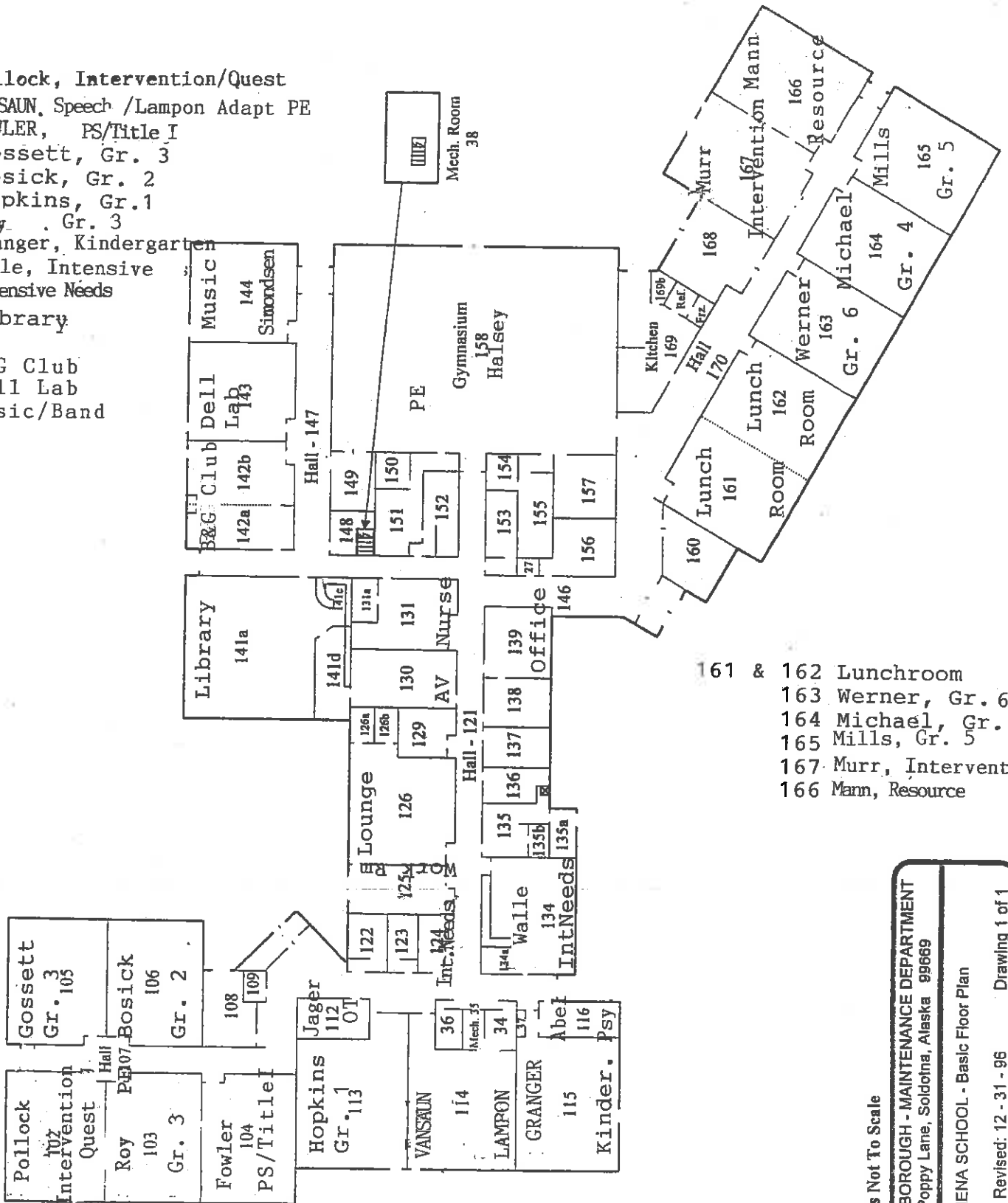

- 161 & 162 Lunchroom
- 163 Werner, Gr. 6
- 164 Michael, Gr. 4
- 165 Mills, Gr. 5
- 167 Murr, Intervention
- 166 Mann, Resource

NOTE: Drawing Is Not To Scale

KENAI PENINSULA BOROUGH - MAINTENANCE DEPARTMENT
 47140 East Poppy Lane, Soldotna, Alaska 99669

TUSTUMENA SCHOOL - Basic Floor Plan

By: MGM Revised: 12 - 31 - 96 Drawing 1 of 1